

Work Instruction Number 109 - "Workforce in Road" signs (Relaxation Works)
 All Amberon "Traffic Management Installations or Removals on any main road or approaching road works 40mph and above" (unless the site specific risk assessment deems it necessary on lower speeds of 40mph) must display the "Workforce in road Slow" sign, this being the 1st Sign out and last sign in.

WORKFORCE
 IN ROAD
 SLOW

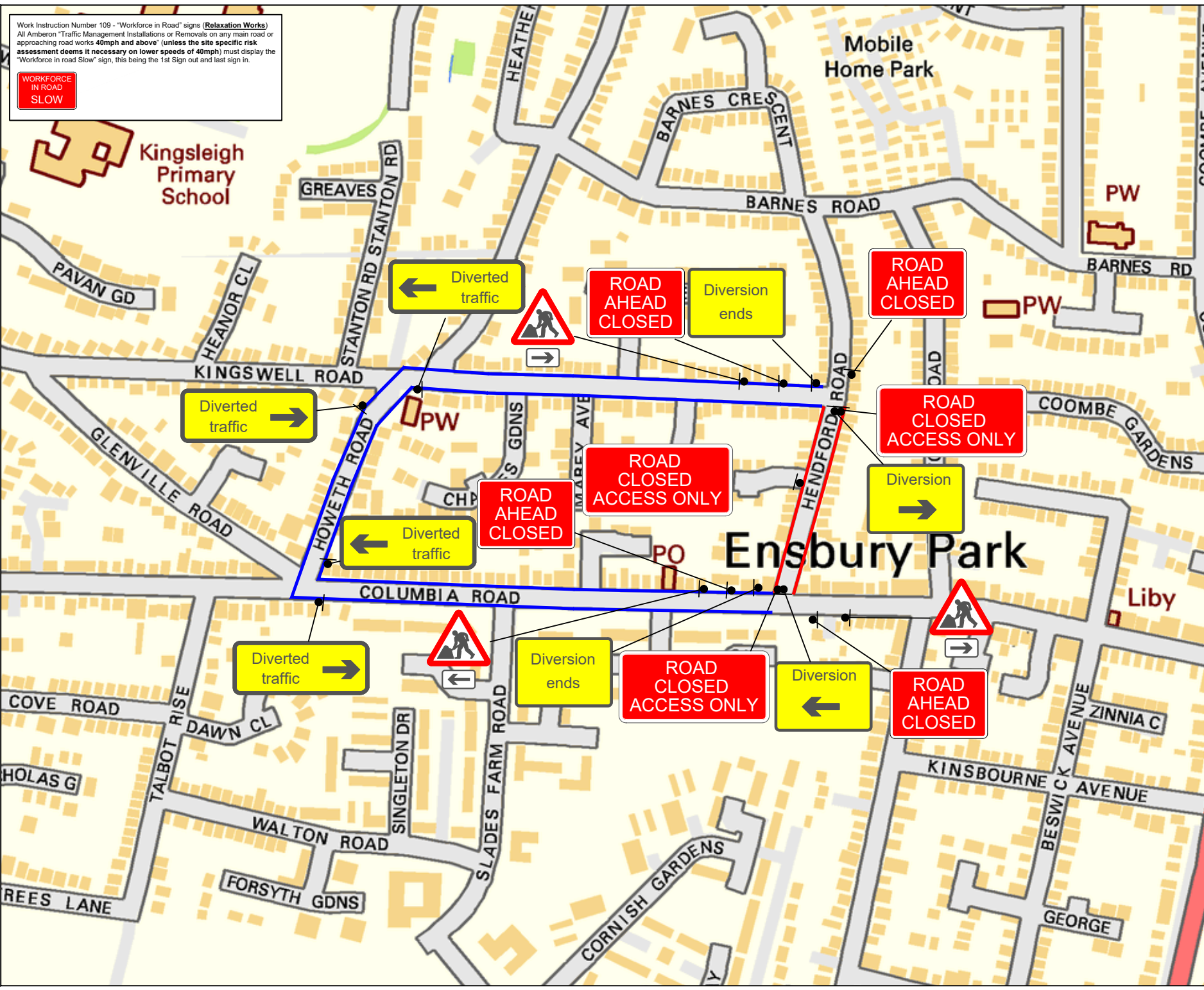

TRAFFIC MANAGEMENT NOTES:
 1) All temporary traffic management shall be in accordance with Chapter 8 of the Traffic Signs Manual 2009.
 2) All temporary traffic management shall be in accordance with the Traffic Signs (Amendment) (No 2) Regulations and General Directions 2016.
 3) All temporary traffic management shall conform to the Safety at Street Works and Road Works, A Code of Practice.
 4) All temporary traffic management signs should be located 450mm min from the kerb face.
 5) All temporary traffic management sign locations are indicative and are subject to on site approval from the Engineer.

QTY: 2	REF: 573	Direction to hazard	
QTY: 3	REF: 7001	Road works ahead	
QTY: 4	REF: 7010.1	Nature of temporary hazard ahead - Road Ahead Closed	
QTY: 2	REF: 2702	End of temporary diversion route (left)	
QTY: 2	REF: 2703	Direction of temporary diversion route from junction ahead (right)	
QTY: 2	REF: 2703	Direction of temporary diversion route from junction ahead (left)	
QTY: 1	REF: 573	Direction to hazard (variant)	
QTY: 1	REF: 2702	Start of temporary diversion route (left)	
QTY: 1	REF: 2702	Start of temporary diversion route (right)	
QTY: 3	REF: A LABEL		

Phase 3

Key

- Traffic sign
- Traffic cone/cylinder
- No waiting cone
- Pedestrian barrier
- Road closure
- Diversion route

Checked by: Jonny Barber
 Customer: SSE
 Job Reference: Chris Ibbotson
 Location: Henford Rd, Bournemouth, BH10 4ED
 Date: 05/06/2020
 Description: Road Closure + Diversion
 Scale: NTS

Amberon Ltd
 Tel: 0845 371 5050

Produced By: Vicki Wilkins
 Drawing Ref: 05/06/2020-VW-1695
 This Drawing is subject to Copyright and remains the property of Amberon Ltd.